

TRIMATIC™45/9.5

DIMAR as always aware of the requirements and problems in woodworking, has created a new product, Trimatic 45/9.5. This article is dedicated to craftsmen and hobbyists who have drilling problems when fitting hinges in modern furniture. Trimatic 45/9.5 allows making the three holes required to fix the hinge in a single pass using a normal pillar drill or portable electric drill. Trimatic 45/9.5 like all our articles maintain the characteristics which distinguishes us in the market, that is: simplicity, speed and accuracy in work performance. Trimatic 45/9.5 is a drilling jig for hinges, with distance between centers of the retaining screws of 45 mm and an offset of 9.5 mm with respect to the centre of the main hinge hole (see Fig. 1)

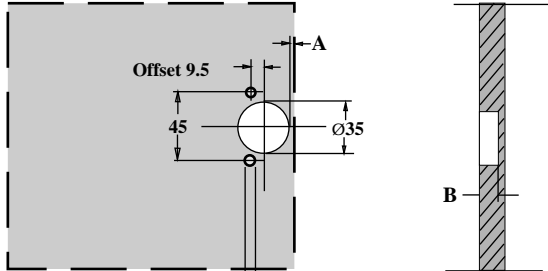

Ø depending on the bush or screw when the bush is not used

Fig.1

The equipment as it appears at the time of purchase (see Fig. 2)

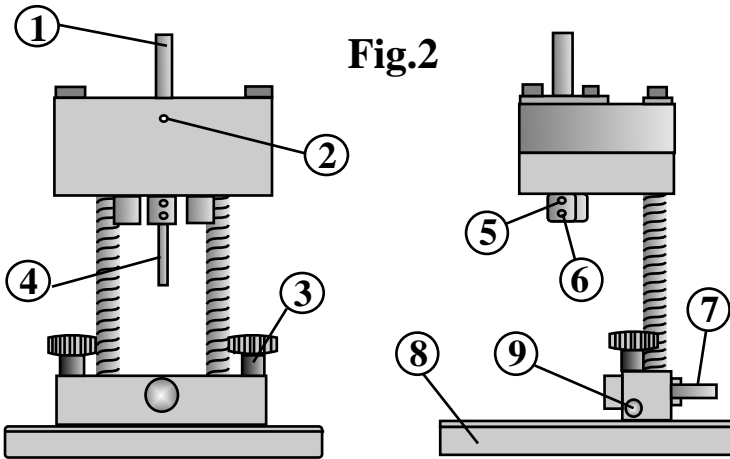

- 1) Fitting for drill spindle
- 2) Threaded hole for greasing
- 3) Locking knob for stop reference rod
- 4) Distance adjusting screw "B"

- 5) Tool holder bush
- 6) Tool locking screw
- 7) Distance adjusting screw "A"
- 8) Equipment support table
- 9) Stop rod sliding hole

Equipment setup and operating phases
Disassemble the support table (6) and position the equipment on a surface suitable for the type of work. Procure a rod with a diameter and length suitable for the job to be carried out and insert it in the hole (9). Position the reference stop and lock the whole assembly with knobs (3). Fix one or more reference blocks on the work surface depending on the length of the door to be drilled. Adjust the screws (7) and (4) (see Fig.2) according to the distance "A" and "B" (see Fig.1). Finally, position the door to be drilled (see Fig.3)

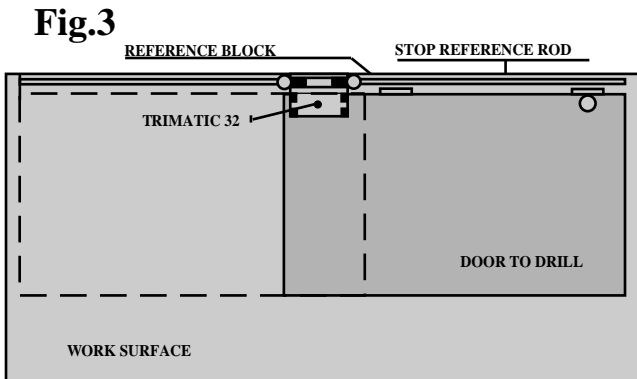
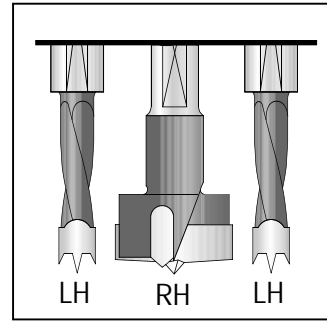

Fig.3

Mount the right boring bit for hinges in the central bush and lock it with the screws (6) mount the dowel drills in the lateral bushes and lock them with the screws (6) (see Fig.4)



Please refer to our wide selection of Carbide Tipped Drills (BKP series) in our catalogue.

When the equipment has been set up, all that is required is an electric drill (recommended power 0.75 kW) to be mounted on the spindle (1) or alternatively, a pillar drill may be used (see Fig.5)

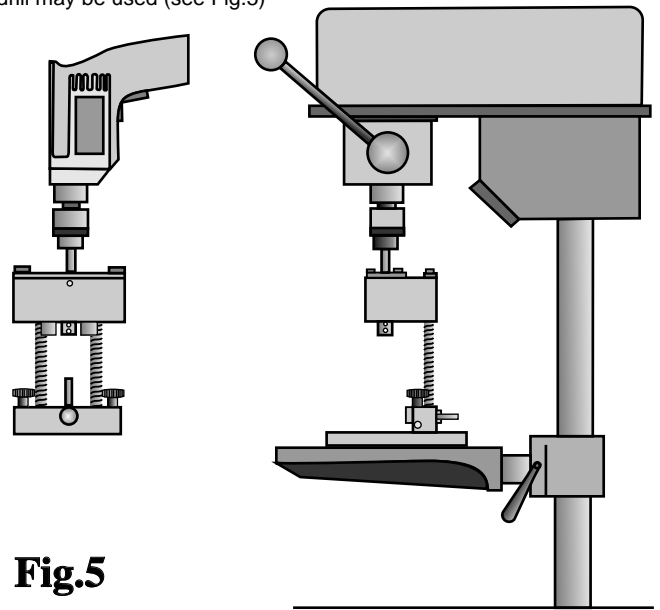

Fig.5

Having selected the type of drill, you can start drilling.

To assist you in the selection of the number of hinges to use on a door, the diagram below shows the number of holes on the basis of the height.

The diagram is approximate; the number of hinges depends not only on the height, but also on the weight and thickness of the material.

