

Carbide Tipped Saws for Miter Saw Machines

Precision quality saw blades specially suitable for Miter Saw Machines, compatible with known brand names.

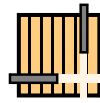

Laminate Boards:
Across & Along

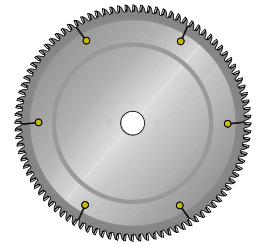

Manufacturing Technology:

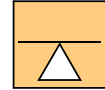

Balance

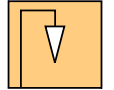

Straight

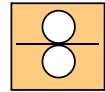

Tension

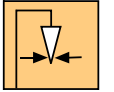

Dynamic Straightness

Tool no.	Dia.	Teeth	Kerf	Bore	Category
8-48 TN	8"	48	.118" (3.0mm)	5/8"	S
10-80 TN	10"	80	.134" (3.4mm)	5/8"	S
10-80 TNX	10"	80	.126" (3.2mm)	5/8"	S
12-96 TN	12"	96	.134" (3.4mm)	1"	S
14-108 TN	14"	108	.134" (3.4mm)	1"	S
16-120 TN	16"	120	.157" (4.0mm)	1"	S

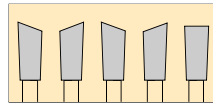
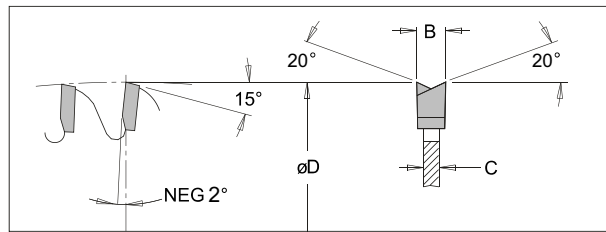

Combination Carbide Tipped Saws for Miter Saw Machines

Among the most popular applications are Miter Joint cuts in:

- * Soft and hardwoods
- * Painted mouldings
- * Gesso (a white paint mixture consisting of a binder mixed with chalk, gypsum, pigment, or any combination of these)
- * High-gloss and pre-finished picture frames
- * PVC substrates (PVC is a thermoplastic polymer)

Precision quality saw blades specifically suitable for working on single or double cut-off miter machines and radial arm saws. Unique tooth configuration of 4 Teeth ATB and 1 Raker together with Negative hook, makes these blades the right choice for a wide cutting applications.

Tool no.	Dia.	Style	Teeth	Kerf	Bore	Category
10-80 MTR	10"	MTR Neg.	80	.114" (2.9mm)	5/8"	S
12-80 MTR	12"	MTR Neg.	80	.122" (3.1mm)	1"	S
12-100 MTR	12"	MTR Neg.	100	.118" (3.0mm)	1"	S

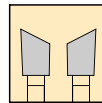
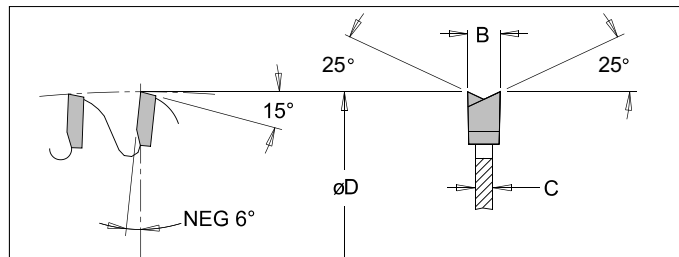
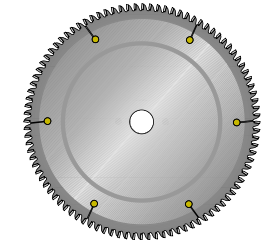

Carbide Tipped Saws for Miter Saw Machines

Precision quality saw blades specially suitable for Miter Saw Machines, compatible with known brand names.

Tool no.	Dia.	Style	Teeth	Kerf	Bore	Category
8.5-48 ATB	8 1/2"	ATB Neg.	48	.100" (2.6mm)	5/8"	S

Manufacturing Technology:

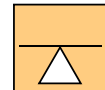

Balance

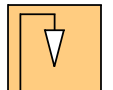

Straight

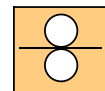

Tension

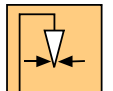

Dynamic Straightness

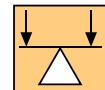

Dynamic Balancing

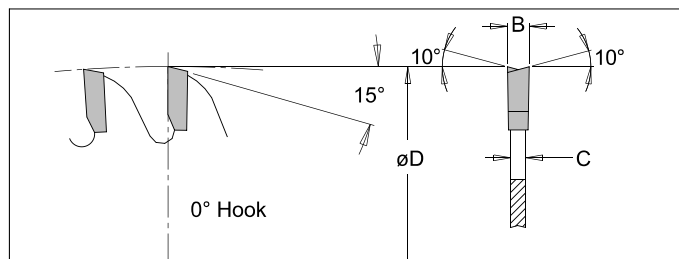

Carbide Tipped Saws for Miter Saw Machines

Precision quality saw blades specially suitable for Miter Saw Machines, compatible with known brand names.

Tool no.	Dia.	Style	Teeth	Kerf	Bore	Category
10-72 ATB	10"	ATB 0°	72	.126" (3.2mm)	5/8"	S

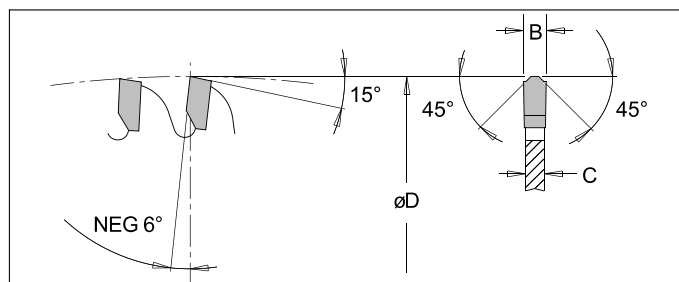

Carbide Tipped Saws for Miter Saw Machines

Precision quality saw blades specially suitable for Miter Saw Machines, compatible with known brand names.



Tool no.	Dia.	Style	Teeth	Kerf	Bore	Category
13-80 N/F-32	13" (330mm)	TCG Neg.	80	.126" (3.2mm)	32mm	S
13-102 N/F-32	13" (330mm)	TCG Neg.	102	.126" (3.2mm)	32mm	S
15-100 N/F-32	15" (380mm)	TCG Neg.	100	.110" (2.8mm)	32mm	S
15-100 N/F	15" (380mm)	TCG Neg.	100	.110" (2.8mm)	1"	S